

DX-350/355 Accessory and I/O Configuration Reference Guide (Website)

STANDARD ACCESSORIES/SPARE PARTS (Include with the unit)

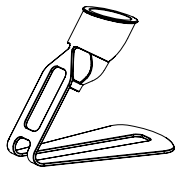

SH-300
Syringe Holder



7045-0120
Air Line Holder

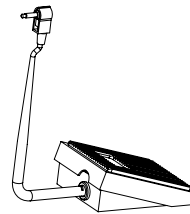

7045-9020
Foot Switch

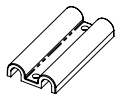

7045-0080
Wire Bracket Holder

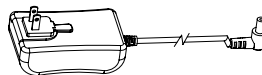

1700-0014
Power Adapter



FTKIT
Air Hose Fitting

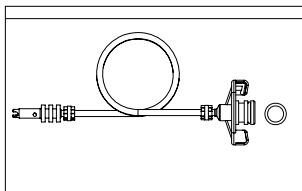

910-3RHB
10cc Receiver head Assembly

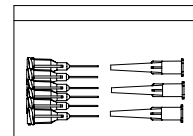

DXSAMPLENEEDLE
TE/TT Sample Needles

OPTIONAL ACCESSORIES (Not include with the unit)



881-000-000
Inline Filter (Optional)



TSD800-6
Air Filter (Optional)

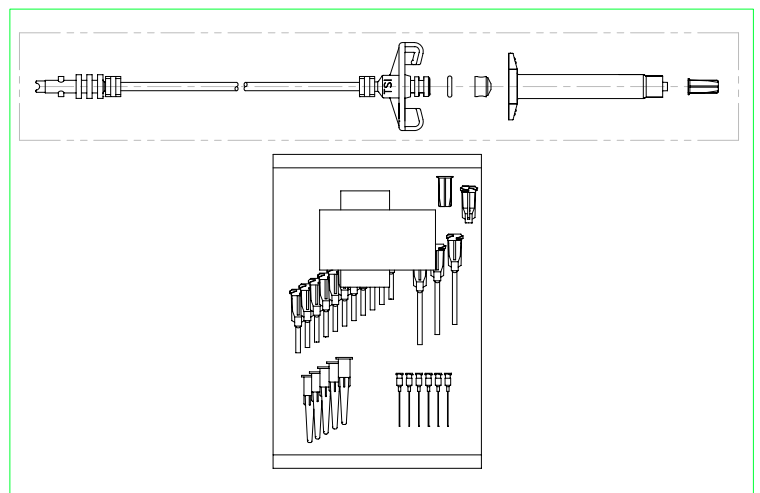

700KIT
Receiver Head Assembly
And Needle Kit (Optional)

Spare Parts/Repair Parts

Part Number	Description
TSD500-48	Air Regulator, 0 - 15 psi (DX-355)
TSD500-30	Air Regulator, 0 - 100 psi (DX-350)
2900-0015	LCD
7066-9010	PCBA
TSD650-21	Solenoid Valve
INTFKIT	Internal Fitting/Tubing Kit
TSD210-3	Valve, Needle
TSD201-22	Check valve
7044-0120	Vacuum Venturi
535	Coupler, Panel Mt. Quick Disc. Assy. Black
TSD1121-22	Knob, Small
TSD1121-23	Knob, Large

I/O Configuration and End of Cycle Switch

During a dispense cycle, an open collector circuit closes and remains closed while the valve is dispensing. This circuit can be used to signal back to a host computer, start another device in sequence, or drive any other operations that need to be tied to the dispense cycle. Power from an external source is allowed to pass through the circuit to operate a 5 to 24 VDC load. Power consumption must not exceed 250 mA. The load could be a relay, solenoid, counter, LED, or any device that will operate within a 5 to 24 VDC range and a maximum of 250 mA.

Note:

During the dispense cycle, pin 3 will be grounded. Please make sure the external device (your machine that controls the dispenser/controller) has the same ground as the DX-350/355.

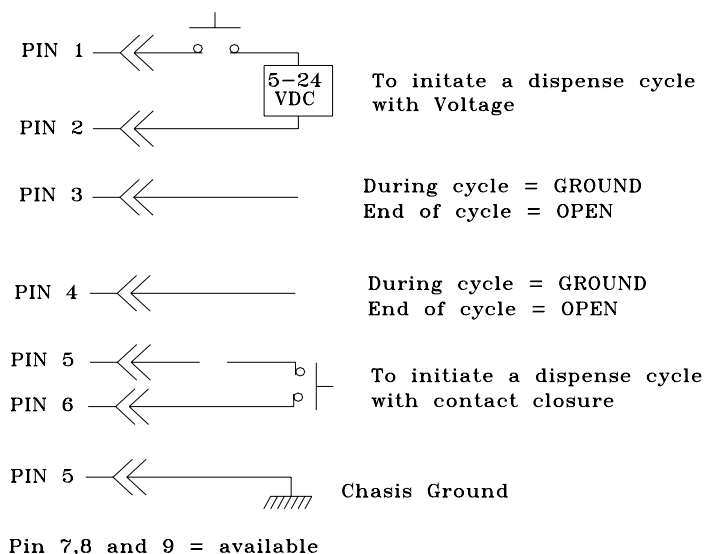

ELECTRICAL SCHEMATIC

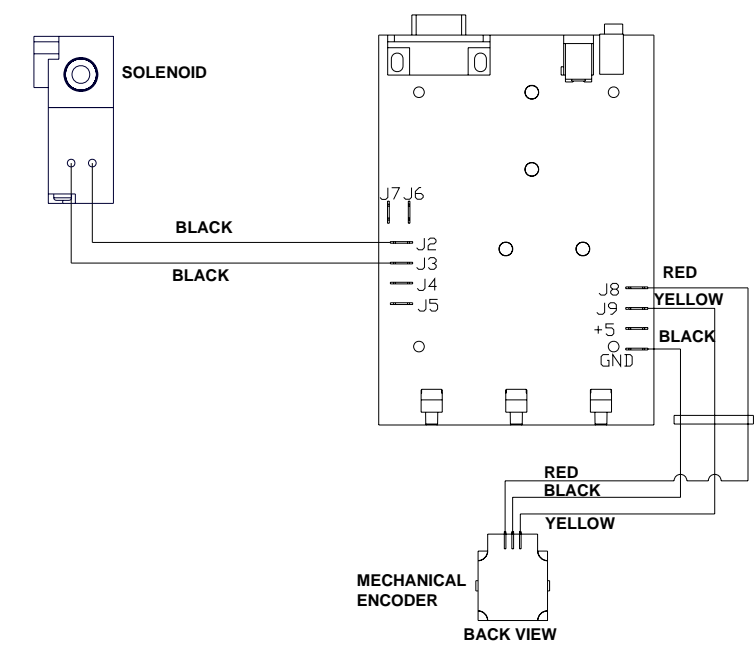

PNEUMATIC DIAGRAM

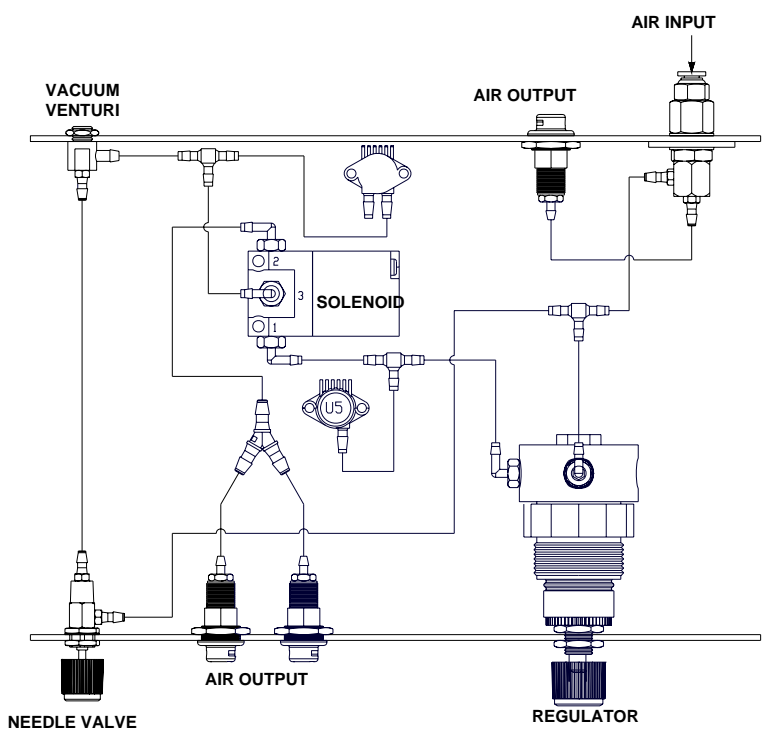

Mouser Electronics

Authorized Distributor

Click to View Pricing, Inventory, Delivery & Lifecycle Information:

[OK International:](#)

[2900-0015](#) [7066-9010](#) [TSD500-30](#)